

Enter Northbound Canova

Exit to the right

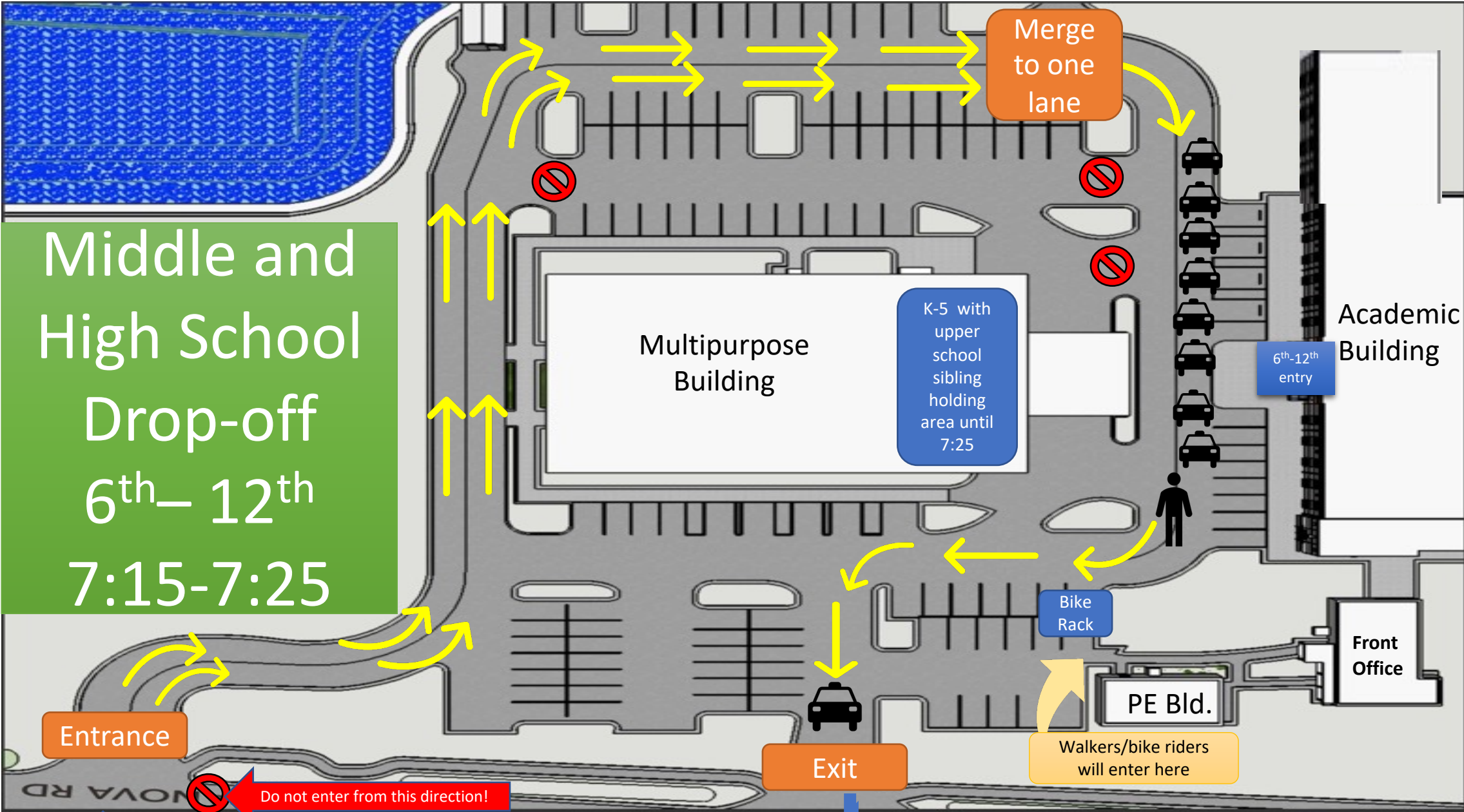

Enter Northbound Canova

Exit to the right

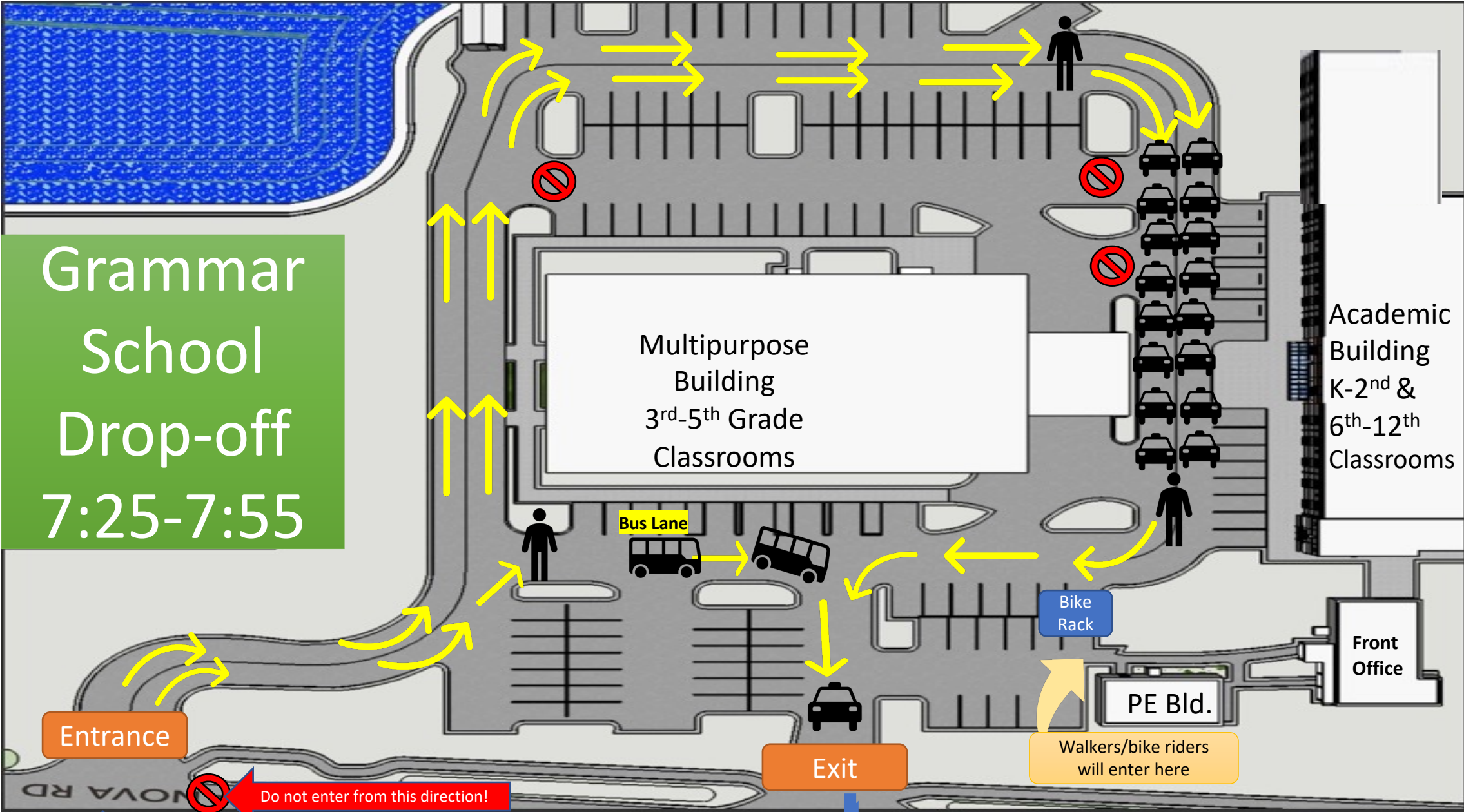

Grammar School Drop-off 7:25-7:55

Multipurpose Building 3rd-5th Grade Classrooms

Academic Building K-2nd & 6th-12th Classrooms

Front Office

PE Bld.

Walkers/bike riders will enter here

Bike Rack

Bus Lane

Entrance

Exit

Do not enter from this direction!

Enter Northbound Canova

Exit to the right



Enter Northbound Canova

Exit to the right

SJCA Placard must be displayed. Staff will record your number here.

Grammar School Dismissal 2:55-3:25

***DO NOT ENTER UNTIL 2:50
Lane closes when car line ends (approximately 3:15)

Do not switch lanes!

Do not switch lanes!

Multipurpose Building

Academic Building

Bus/carpool lane

Lanes reserved for missing students

Entry Gate

PE Bld.

Front Office

Entrance

Exit

Walkers/bike riders will exit here

Only BUS & CARPOOL enter from this direction

Enter Northbound Canova

Exit to the right

